

galcoholsters.com



Galco Customer Service can be reached Toll Free at 800-874-2526 or by Email at:

Visit galcoholsters.com/videos to view related safety videos.



Used to address practices unrelated to potential personal injury.

**NOTICE**

Indicates a hazardous situation which, if not avoided, will result in minor or moderate injury.

**CAUTION**

Indicates a hazardous situation which, if not avoided, will result in death or serious injury.

**WARNING**

Indicates a hazardous situation which, if not avoided, will result in death or serious injury.

**DANGER**

SAFETY SYMBOL DEFINITIONS

IMPORTANT SAFETY WARNINGS AND INSTRUCTIONS READ PRIOR TO USING GALCO PRODUCTS

**DANGER**

Firearms users must understand and obey the Rules of Firearm Safety:

1. Treat all firearms as if they are always loaded.
2. Never point a firearm at anything you aren't willing to shoot.
3. Keep your finger off the trigger until you intend to shoot.
4. Be sure of your target and what is behind/beyond it.

Read and understand all owner's manuals, instructions, and guides prepared by the manufacturer of your firearm prior to use. If you have any questions about correct fit, contact Galco Customer Service at 800-874-2526 or customerservice@galcoholsters.com. You may also visit us at galcoholsters.com where you can use our online fitting guide.

**WARNING** Carrying a firearm with an ill-fitting or improper holster can result in serious injury or death. The purchase and use of a Galco holster is at the sole and exclusive risk of the user.

READ AND UNDERSTAND THIS ENTIRE GUIDE PRIOR TO USING THIS PRODUCT

Firearms are inherently dangerous. Improper or careless use of a firearm or firearm and holster may result in serious injury or death. It is the user's responsibility to possess a thorough knowledge of, and be properly trained in, all aspects of firearm use, including holster use and safety.

Carry the firearm in the safe condition recommended by its manufacturer. This information will be contained in the product information manual provided by the firearm manufacturer. If you do not have the manual applicable to the firearm, contact the firearm's manufacturer.

It is the user's responsibility to maintain the holster by regularly checking component parts for excessive wear and proper function.

**WARNING** Failure to heed these warnings or follow the operating instructions may result in negligent discharge of a firearm, causing serious injury or death.

**WARNING** Do not in any way modify, disassemble or remove any part from this holster, except as approved and recommended in Galco's Product Information Guide.

Always place your hand on the firearm when you are performing other physically vigorous activities.

Checking tension units each time the holster is used is required as part of your regular safety inspection. Applying a small amount of clear nail polish to the threads of the tension units, after proper adjustment, will help minimize screw loosening.

**WARNING** Tension units are not pre-set at the factory. If a holster has tension units, it is the user's responsibility to ensure they are adjusted to retain the firearm.

**CAUTION** Always protect an exposed magazine release from accidental activation.

**WARNING** When drawing a firearm or engaging it with the holster, DO NOT place your finger on the trigger, in the trigger guard, or near the trigger. Position your finger along the frame of the firearm above the trigger guard. Keep your finger off the trigger until your sights are on target.

**WARNING** If the firearm is not properly secured by means of friction from the holsters molding or of the retention device(s), it could become dislodged, causing injury and possibly death to the user and others.

**WARNING** A firearm (whether in or out of a holster) may discharge if it falls to the ground or onto another object, causing death or serious injury. Holsters are not designed or intended to prevent firearms from discharging when dropped.

**WARNING** A holster is not a replacement for a safe. Firearms should be secured in a locked safe when not in use. Firearms should not be stored in holsters for long periods, even when in a safe. The holster may trap moisture against the firearm and promote corrosion.

**WARNING** A significant number of negligent discharges - some resulting in injury or death - occur while holstering a firearm. Most are caused by the user's index finger pressing the trigger. Some are caused because a foreign object becomes entangled or trapped in the trigger guard/holster and presses the trigger. The safest practice is to "look the firearm into the holster". This should be done methodically and without rushing. While holstering, be fully cognizant that:

1. All safeties are engaged.
2. Your index finger is straight along the firearm's frame. DO NOT place your finger on the trigger, in the trigger guard, or near the trigger. Keep your finger off the trigger until your sights are on the target.
3. No articles of clothing (shirt tails, jacket drawstrings, etc.) become trapped in the trigger guard, holster, or between the firearm and holster.
4. Your shooting-hand thumb is placed over the hammer or the rear of the slide. This will enable you to feel if the hammer starts to move rearward or the slide begins to come out of battery.

5. You strictly observe Rule of Firearms Safety #2: never point a firearm at anything you aren't willing to shoot. If you do not know how to holster your firearm without breaking this rule, you should seek training before holstering your firearm while the holster is worn.

6. If for any reason you are unable to "look the firearm into the holster" and not muzzle yourself or others, you should remove the holster from your body, then "look the firearm into the holster" (without breaking Rule #2). After the firearm is securely seated in the holster, attach the holster to your body/clothing in the manner in which it was designed.

7. If you holster your firearm while the holster is off and in your hand, insure you do NOT point the firearm at your support hand. Do not place your support hand (or other body parts) at the bottom of the holster. The holster material is not bullet proof. Neither your support hand, other body parts, nor other people should be muzzled/flagged while holstering.

CARRY CONDITION OF THE FIREARM

**WARNING** Some single-action revolvers and some semi-automatic pistols must be carried with the hammer or firing pin resting on an empty chamber.

Carrying any firearm with a live cartridge in the chamber immediately in front of the firing pin may cause a negligent discharge. Information regarding the safe carry condition of your firearm will be contained in the product information manual provided by the firearm's manufacturer. If you are unsure of the safe carry condition(s) of your firearm, contact the firearm's manufacturer.

**WARNING** Never holster a firearm in the single-action mode, unless it is a semi-automatic pistol and holster designed and intended for "cocked and locked" or "Condition One" carry. Always ensure that a single-action pistol carried in "Condition One" has the manual safety engaged when carrying in a holster.

**WARNING** Do not use customized, modified, worn or broken firearms, or those otherwise outside the original manufacturer's specifications, with a Galco holster.

**WARNING** Do not place a loaded firearm in a holster without first testing - with a firearm double-checked and verified to be unloaded - for proper firearm fit.

**CAUTION** Do not attempt to cock a holstered firearm as this may damage the firearm, the holster, or both and may contribute to a negligent discharge.

IF ANY DOUBT EXISTS AS TO THE SERVICEABILITY OR SAFETY OF A GALCO PRODUCT, IMMEDIATELY CEASE USING IT!

If you have questions, contact: Galco Customer Service at 800-874-2526 or customerservice@galcoholsters.com

Galco has made every effort to properly label all holsters for the specific firearms they fit. However, firearms manufacturers often make changes to their firearms that affect holster fit.

Galco will not be responsible for such changes, nor for typographical or other human errors that may occur. It is the user's responsibility to ensure proper holster fit with actual firearms.

It is important to understand that all products, including firearms, holsters and slings may eventually "wear out" or become unsuitable for the function for which they were designed. Stress and strain placed on a product will vary according to frequency and conditions of use, and therefore it is difficult to indicate a recommended replacement date for this product.

PRODUCT IDENTIFICATION

Galco products are generally identified with a two-part code stamped into the holster body or label affixed to the item.

An alphabetical or alphanumeric prefix identifies the holster model. For example, the FLETCH model's prefix is FL while the Royal Guard's prefix is RG.

The numerical suffix identifies the particular firearm the holster is intended to fit. For example, the 212 suffix indicates a 5" 1911 while the 224 suffix indicates a Glock 17. The letter "B" or "H" at the end of the code indicates color. B is for black, H for havana brown, while no letter generally indicates tan.

Thus, an FL212 (FL + 212 + no letter) will be a tan FLETCH to fit a 5" 1911, while an RG224B (RG + 224 + B) will be a black Royal Guard for a Glock 17.

Codes containing the letter 'R' in the suffix indicate that the holster accommodates most carry-style micro red dot optics (MRDO). For example, a tan Concealable 2.0 belt holster for the Glock 19 w/wo MRDO would be marked CO2-226R.

Holsters intended for Galco's modular shoulder systems display letters and numbers that correspond to guns. A Miami Classic holster intended for a SIG P320, for example, will simply read 820.

The numerical suffix of holsters intended for right-hand or ambidextrous use will end in an even number. The suffix of holsters intended for left-hand use will end in an odd number.

You may use the search field found at our website, galcoholsters.com, to locate a holster fit. Simply enter the model number on the item (FL224RB, for example) in the field.

**WARNING** Galco holsters are approved for use with multiple firearms. Care must always be taken to ensure your holster is an appropriate and approved fit for your firearm.

REPAIRS

Great care was taken to select the finest materials available to craft your Galco product. It was designed in accordance with the highest engineering standards and hand made using traditional leather craft practices that have become Galco hallmarks over five decades. In the unlikely event a repair is necessary to an unaltered Galco product, simply contact our Customer Service department at 800-874-2526 or customerservice@galcoholsters.com. We will issue you a Return Authorization (RA) number to print on the outside of your shipping container and provide you with detailed shipping instructions.



PRODUCT INFORMATION GUIDE  
POCKET HOLSTERS & ACCESSORIES

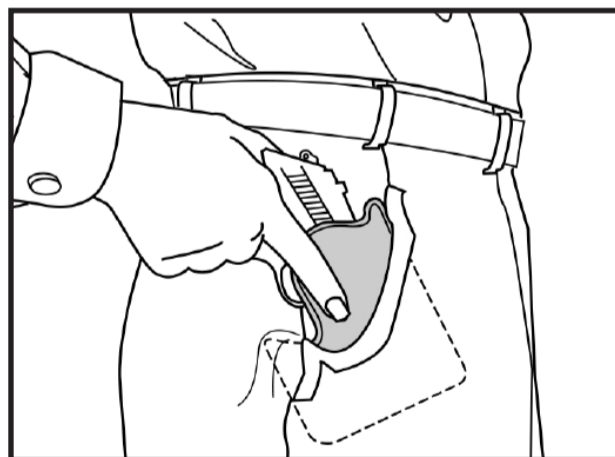

galcoholsters.com



LARGER PRINT AVAILABLE

THANK YOU FOR YOUR PURCHASE - WE APPRECIATE IT!

## POCKET HOLSTERS

Pocket carry offers unique advantages. The gun carrier can casually place a hand on the holstered pistol if a non-specific threat materializes - and the fastest draw is to have the gun in hand. While commonly used in a front pants pocket, jacket and cargo pant pockets are often applicable, as well. Galco's pocket holsters conceal the shape of the gun so that its outline is not printed through the garment.

Galco pocket holsters are designed to keep the handgun or magazine in a consistent and upright position for ease of draw. The holsters are designed to catch on the pocket so that, with practice (using an unloaded firearm) the firearm or magazine can be drawn with a "hooking" technique as shown in illustrations. This allows a smooth draw of the firearm or magazine while the holster remains in the pocket or falls away.

**WARNING** Always remove the holster from the pocket before holstering the handgun!

## FRONT POCKET HORSEHIDE HOLSTER

Galco's Front Pocket horsehide holster is constructed from premium horsehide. The holster uses two leather hooks, which catch the top or bottom pocket corner on the draw.

## POCKET PROTECTOR HOLSTER

Galco's Pocket Protector™ is constructed of Premium Center Cut Steerhide™. Reinforcements at the leather mouth and beneath the trigger guard keep the holster stiff enough to allow a smooth draw. The holster's hook at the base of the firearm's trigger guard is designed to catch on the bottom corner of the pocket.

## STUKON-U POCKET HOLSTER

The StukOn-U™ holster's Gripper Shell™ surface and denier packcloth lining assist in keeping the holster in the pocket during the draw. Combined with the "hooking" technique illustrated, this allows one-handed release of gun from both pocket and holster.

## POCKET MAGAZINE CARRIER

The Pocket Magazine Carrier (PMC™) is constructed from Premium Center Cut Steerhide and carries a single spare magazine in the support-side pocket. The PMC features an adjustable tension unit. The hooked shape is designed to catch on the corner of the pocket and retain the carrier in the pocket during the draw.

**WARNING** Keep your finger off the trigger until your sights are on the target!!

## INSPECTIONS + MAINTENANCE, ADDITIONAL USER RESPONSIBILITIES

**WARNING** It is the user's responsibility to ensure that the Galco product remains serviceable and safe, and able to continue service within its design

**NOTICE** It is the user's responsibility to inspect the holster before and after each use for signs of excessive wear or loss of retention capability while being worn as designed, and appropriate tightness of all hardware.

## DO

**NOTICE** Ensure that all screws are tightened snugly. Applying a small amount of clear nail polish to the threads will minimize screw back out. Ensure that the holster provides secure gun retention in all circumstances.

Clean as needed progressively by wiping with a soft cloth, soft bristle brush, or soft damp cloth with mild soap to remove stubborn grime. Do not saturate with water and do not run under the tap.

## DON'T

**WARNING** Do not use a loaded firearm in a holster without first testing - with a firearm double-checked and verified to be unloaded - for proper firearm fit.

**NOTICE** Do not put Galco synthetic or leather products in the washing machine. Do not use any solvents or corrosive chemicals on this product.

Do not use artificial heat to speed up the drying process, i.e. from a hair-dryer, oven, radiator, direct sunlight, etc. Do not leave Galco products on the dashboard of your car in summertime. Do not leave Galco products exposed to direct sunlight or excessive heat for long periods of time.

Do not use Loctite® or threadlock. Outgassing from these adhesive compounds will adversely affect plastic, nylon and rubber parts.

The above care and maintenance instructions cannot substitute for your good common sense. Following our recommended care and maintenance tips will allow you to get the maximum service life from all of your Galco products.

## HOLSTER FIT / BREAK-IN

Galco's full grain leather holsters are made of the finest materials and are precision molded to specific firearms. It may appear the holster fit is too tight at first, but this is by design. We engineer our holsters to fit tightly knowing the leather fibers will relax to the proper fit

**WARNING** UNLOAD YOUR FIREARM (Chamber, magazine, cylinder) before testing holster fit.

Tension units are not pre-set at the factory. You may need to adjust them in order to holster your handgun or magazine for the first time. We recommend that you check your tension screw adjustments before each use. Do not use Loctite® on tension units. Galco recommends a single drop of clear nail polish applied to your tension screw threads may reduce its unwanted loosening.

If the fit is too tight when holstering your firearm the first time don't force it. If you do force the firearm into the holster, it may be very difficult to remove. Instead, follow these simple steps to break in your new holster or ammo carrier using a process called blocking:

1. Place the unloaded firearm or magazine in a heavy duty Ziploc-type bag. Do not cover the grip.
2. Insert the bagged firearm/magazine slowly into the holster/ammo carrier, gently twisting it side-to-side to minimize tearing of the bag.
3. Once the firearm/magazine is completely seated in the holster/ammo carrier, twist approximately 1/16" in both directions 6-12 times.
4. Allow the bagged firearm/magazine to sit in the holster/ammo carrier for several hours, or even overnight.
5. Remove the firearm/magazine from the holster/ammo carrier and remove the firearm/magazine from the bag.
6. Insert the unloaded firearm/magazine into the holster/ammo carrier, which should now be snug but not loose. If it's still too tight, repeat the above steps until the holster/ammo carrier is broken in to your satisfaction.
7. If necessary, repeat steps 1-6 with an additional heavy duty Ziploc-type bag.
8. Note that double magazine carriers may need a break-in performed for each magazine slot.
9. Note that OWB/IWB holsters with widely-spaced belt attachments may need to be worn during the break-in process, since the curvature of the worn holster will increase tension compared to not being on

**NOTICE** If your holster has a retention strap: You may need to stretch the retention strap using your fingers only (no tools, no water, no chemicals, etc.) before you get it to snap.

## HOLSTER FIT / BREAK-IN (continued)

1. Place the unloaded firearm in the holster.
2. Hold the firearm grip in your strong hand and the retention strap in your support hand.
3. Prepare the strap for stretching by grasping the snap and pulling the strap taut (removing the slack).
4. Twist the strap 90 degrees back and forth in a clockwise and counterclockwise rotation 10-12 times while keeping it taut.
5. Firmly push the firearm away from you while pulling on the strap and continue rotating the strap.
6. Release the tension for a moment and repeat two or three times.
7. Pull the strap over the back of the firearm without releasing tension.
8. While maintaining the strong tension, attempt to snap the retention strap closed.
9. Repeat step 5 as needed.

Following and repeating the above instructions is the only way to an ideal break-in and long service life with proper fit that will last many years.

It is common for the inside of a leather holster to scratch from a single holstering (called etching). A smooth leather lined holster will be even more subject to this normal occurrence. After this initial etching, the holster will custom fit your firearm. Some modern pistols have very sharp edges, particularly surrounding the ejection port. This may cause an initial feeling of "dragging" on the draw, but will normally resolve quickly with just a few draw-and-holster repetitions.

Try our Draw-Ez™ applied to the inside of your leather holster to shorten the break-in period and provide a slicker draw. Draw-Ez only treats the interior surface of the leather and will not be absorbed by the leather or harm the finish. Do not use Draw-Ez on Premium Center Cut Steerhide.

## FRONT POCKET HORSEHIDE DRAW

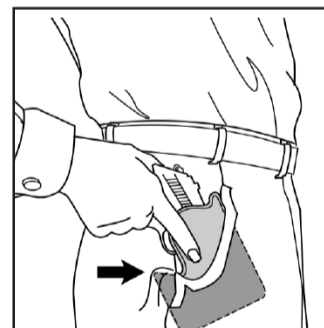
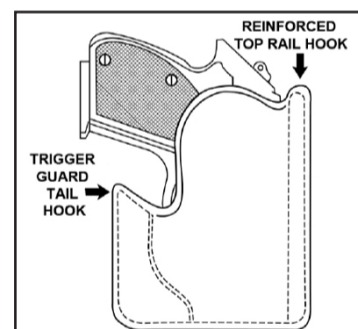

Technique I

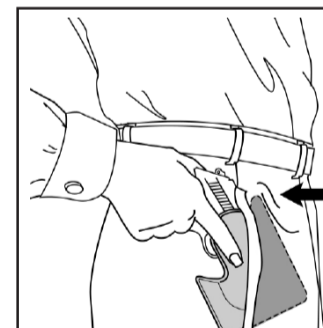

Technique II

Hooking the trigger guard tail hook on the bottom of the pocket while drawing. Hooking the reinforced top rail hook on the top of the pocket while drawing.

## STUKON-U POCKET HOLSTER DRAW

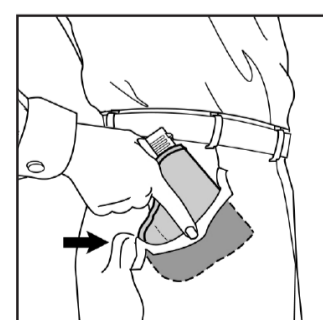
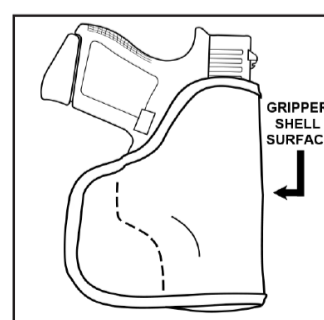

Use a "hooking" draw technique to catch the edge of the holster on the pocket as the handgun is released. The Gripper Shell exterior will help the holster grab the inside of the pocket.

## POCKET PROTECTOR DRAW

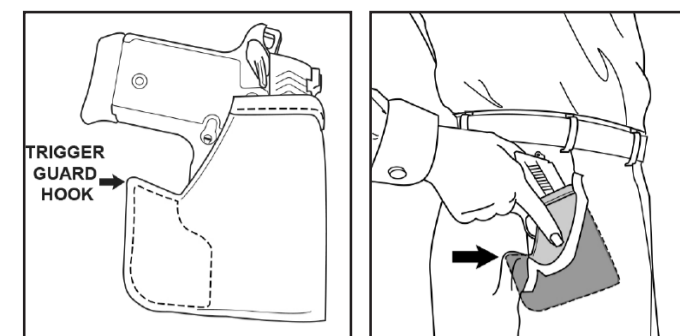

Use a "hooking" draw technique to catch the edge of the holster on the pocket as the handgun is released. Hook the trigger guard hook on the bottom of the pocket while drawing.

## POCKET MAGAZINE CARRIER DRAW

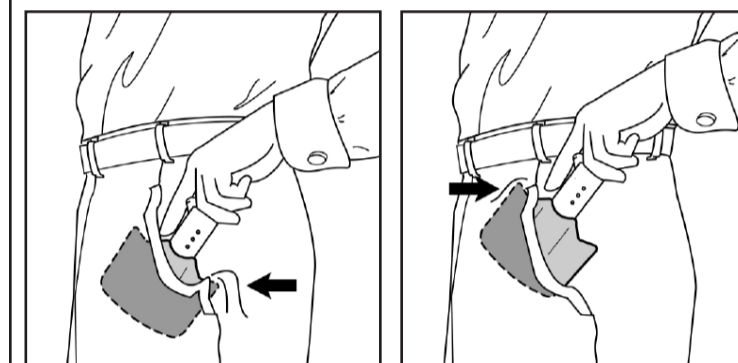
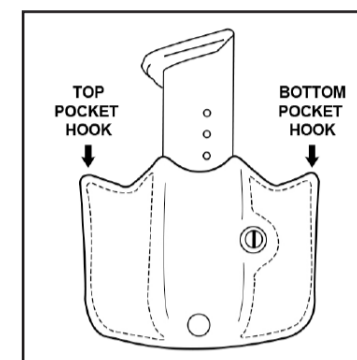

Technique I

Technique II

Hooking the bottom pocket hook on the bottom of the pocket while drawing. Hooking the top pocket hook on the top of the pocket while drawing.

## TERMS OF SALE

Because we have no control over the use of our products, all Galco products are sold as is and "with all faults". The entire risk as to the quality and performance of the product is with the buyer. Should the product prove defective following its purchase, the buyer and not the manufacturer, distributor, or retailer assumes the entire risk of all the necessary servicing or repairs. Under no circumstances shall Galco be liable for incidental or consequential damages, such as loss of use of property, commercial loss and loss of earnings or profits. The implied warranties of merchantability and fitness for a particular purpose and all other warranties, expressed or implied, are excluded from this transaction and shall not apply to the product sold. The determination of the fitness or the suitability of any product for a specific use is the responsibility of the buyer. The illustrations shown herein are typical as to the finish and application. Due to uncontrollable variances in color saturation, the actual product may differ slightly from that shown on our web site. Galco reserves the right to make changes in product built and/or sold by them at any time without incurring any obligation to make same or similar changes on products previously manufactured and/or sold by them. All Galco products are made in the U.S.A. and produced according to rigid specifications. Prices and models are subject to change without notice. Some states do not allow the exclusion or limitation of implied warranties or liability for incidental or consequential damages, so the above limitations and exclusions may not apply to you. Galco designs, features, and model names are the exclusive property of Galco International. Any and all persons including, but not limited to, individuals, firms and/or corporations are forbidden from imitating, copying or reproducing them in any way.